

DISTRICT	COUNTY	ROUTE	SECTION	SHEET
6-0	MONTGOMERY	3052	-	1 OF 1
LOWER MERION TOWNSHIP				
REVISION NUMBER	REVISIONS	DATE	BY	
1	REVISED PER PENNDOT COMMENTS	10/8/12	BJF	
2	REVISED PER PENNDOT COMMENTS	3/05/14	BJF	
3	REVISED PER PENNDOT COMMENTS	5/23/14	BJF	
4	PERMIT AMENDMENT FOR DETOUR PLAN	8/07/14	BJF	

**DETOUR PLAN**

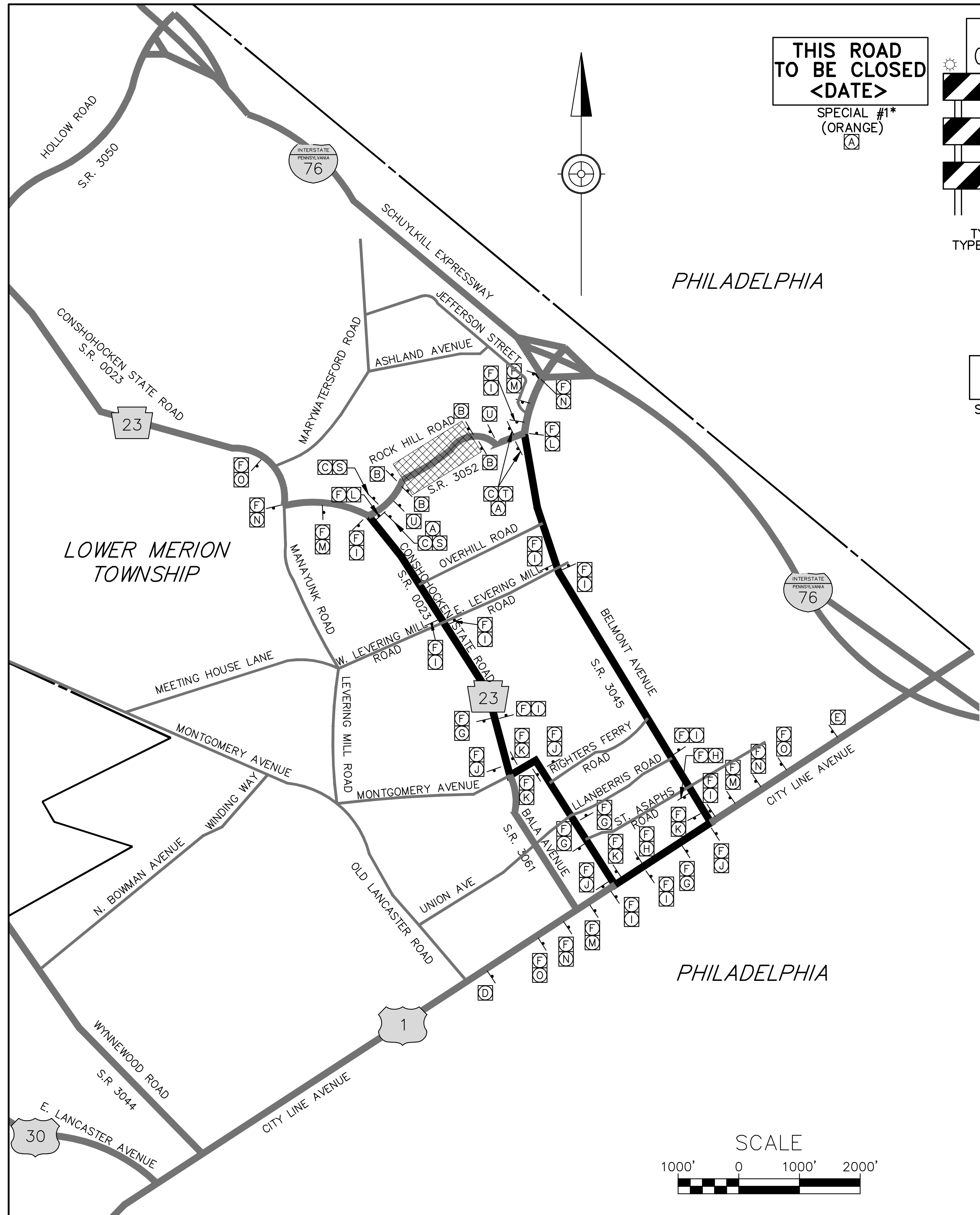

**THIS ROAD TO BE CLOSED <DATE>**  
SPECIAL #1\* (ORANGE)  
A

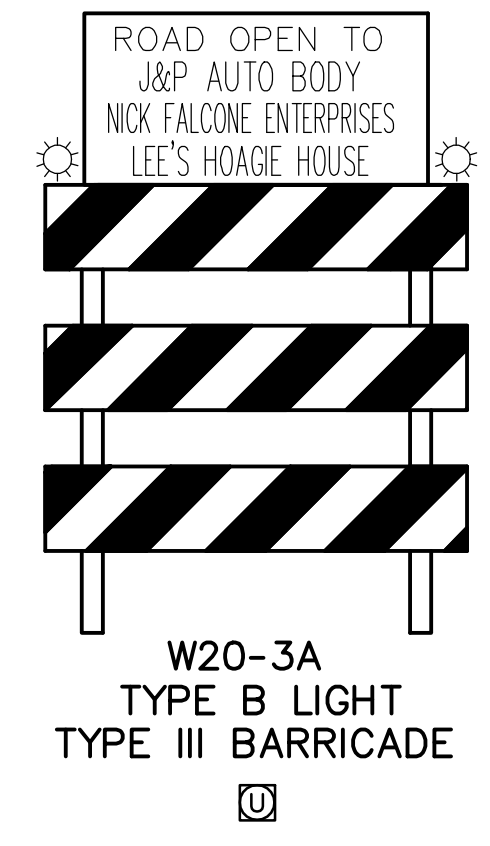
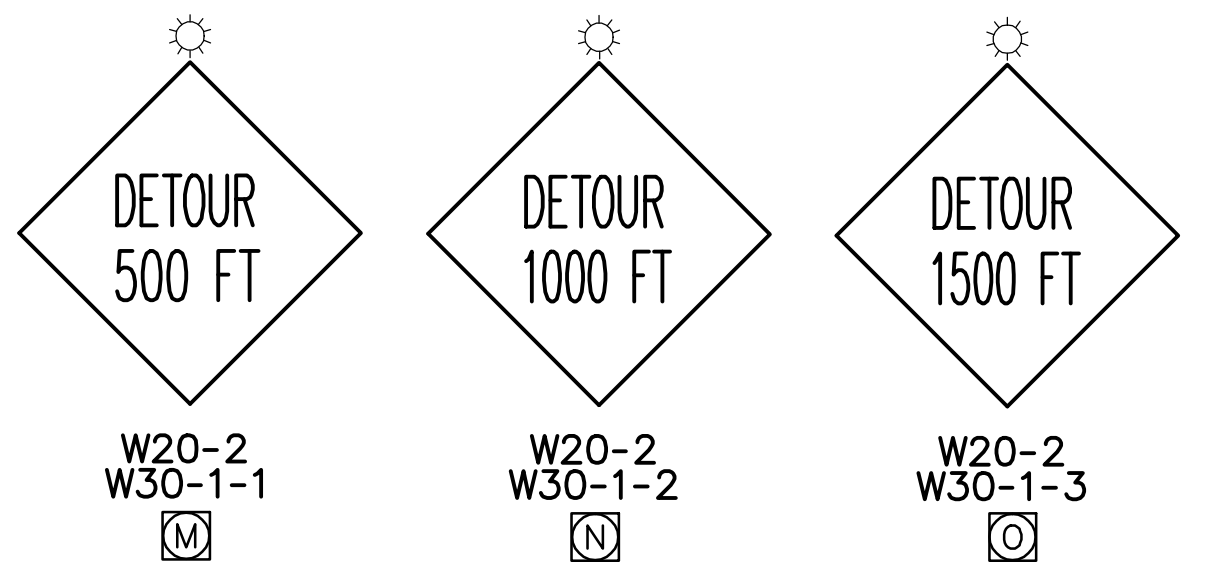
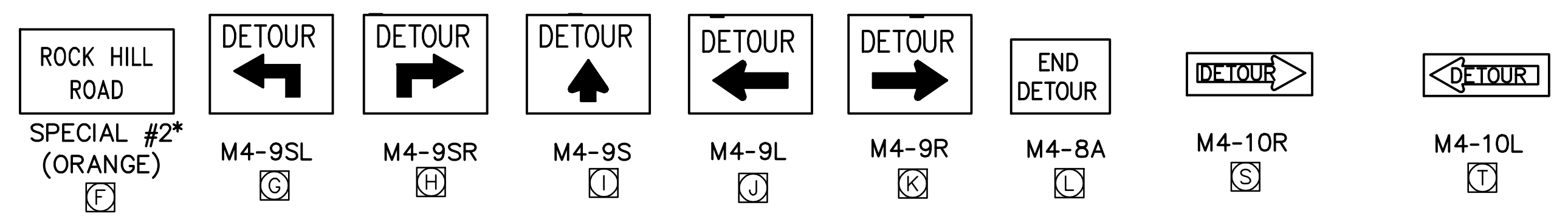
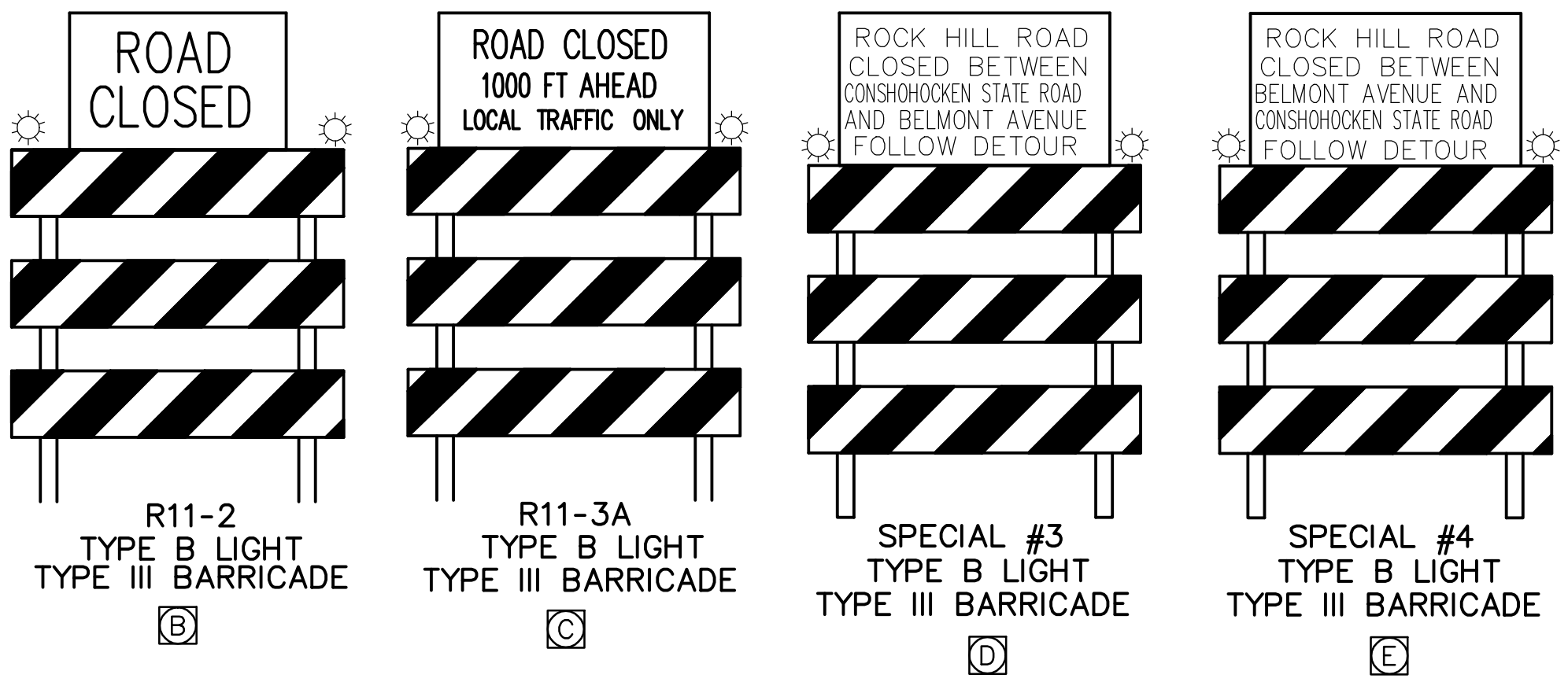

- NOTES:**
- ACCESS WILL BE MAINTAINED TO ALL EXISTING DRIVEWAYS DURING CONSTRUCTION.
  - THE SPECIAL SIGNS (\*) SHALL CONFORM TO THE FOLLOWING:
    - 6" SERIES LETTERING
    - REDUCE LETTERING TO FIT ORANGE REFLECTORIZED BACKGROUND
    - BLACK LEGEND AND BORDER
    - SIZE 18" HIGH X 30" WIDE
  - SIGN 'A' SHALL BE ERECTED 14 DAYS PRIOR TO ROAD CLOSURE
  - WHEN THE DETOUR IS IMPLEMENTED, FIELD ADJUST TRAFFIC SIGNAL TIMINGS ALONG THE DETOUR ROUTE AS NECESSARY.
  - THE CONTRACTOR IS TO COORDINATE WITH THE TOWNSHIP DURING CONSTRUCTION REGARDING ADDITIONAL SIGNING/ TRAFFIC MEASURES THAT MAY BE NECESSARY ON THE RESIDENTIAL STREETS TO MINIMIZE/DIVERT CUT-THROUGH TRAFFIC.
  - CONTACT THE PENNDOT DISTRICT 6-0 TRAFFIC MANAGEMENT CENTER (TMC) AT 610-205-6934 2 DAYS PRIOR TO ROAD CLOSING OR INSTITUTING LANE RESTRICTIONS, AND AGAIN 1 HOUR PRIOR TO COMMENCING WORK. CONTACT THEM AGAIN WHEN ROADWAY IS RETURNED TO FULL OPERATION.
  - THE PERMITTEE/CONTRACTOR IS RESPONSIBLE FOR CONTACTING THE PENNDOT TRAFFIC MANAGEMENT CENTER (TMC) AT 610-205-6934 WHEN THE DETOUR IS REMOVED, OR IF THE DETOUR IS EXTENDED BEYOND THE DECEMBER 12, 2014 DATE.
  - THE PERMITTEE IS RESPONSIBLE FOR PROVIDING LOCAL POLICE MONITORING, AS DEEMED NECESSARY BY THE TOWNSHIP, AT ANY POINT DURING THE CONSTRUCTION.
  - THE 24/7 DETOUR WILL BE IMPLEMENTED FROM SEPTEMBER 9, 2014 TO DECEMBER 12, 2014. SHORT-TERM TRAFFIC CONTROL MEASURES, IN ACCORDANCE WITH PENNDOT PUB. 213M (LATEST EDITION), WILL BE IMPLEMENTED AS NECESSARY BEYOND THIS DATE. ANY DETOUR BEYOND DECEMBER 12, 2014 WILL REQUIRE ADDITIONAL PENNDOT AND MUNICIPAL CONCURRENCE PRIOR TO IMPLEMENTATION.

LEGEND	
	WORK AREA
	SIGN & IDENTIFYING LETTER
	TYPE B LIGHT
	STATE HIGHWAY
	LOCAL ROAD
	DETOUR ROUTE
	MUNICIPAL BOUNDARY



425 COMMERCE DR  
SUITE 200  
FT WASHINGTON, PA. 19034  
TELE: (215)-283-9444  
FAX: (215)-283-9447

860 SPRINGDALE DR  
SUITE 200  
EXTON, PA. 19341  
TELE: (610)-594-9995  
FAX: (610)-594-9565

3903 HARTZDALE DRIVE  
SUITE 301  
CAMP HILL, PA. 17011  
TELE: (717)-975-0295  
FAX: (717)-975-0294

DESIGN BY: JAD  
DRAWN BY: JAD  
CHECKED BY: DAC  
JOB NO: 805382  
DWG: 382DTR01  
DATE: 7/11/08

**131 & 151 ROCK HILL ROAD ASSOCIATES, L.P.**  
2701 RENAISSANCE BOULEVARD  
KING OF PRUSSIA, PA 19406  
PHONE: (610) 337-5582

**ROCK HILL ROAD (S.R. 3052)**  
LOWER MERION TOWNSHIP MONTGOMERY COUNTY

